

BEVERAGE COOLER

User Manual

SKU : ZX-WC-145

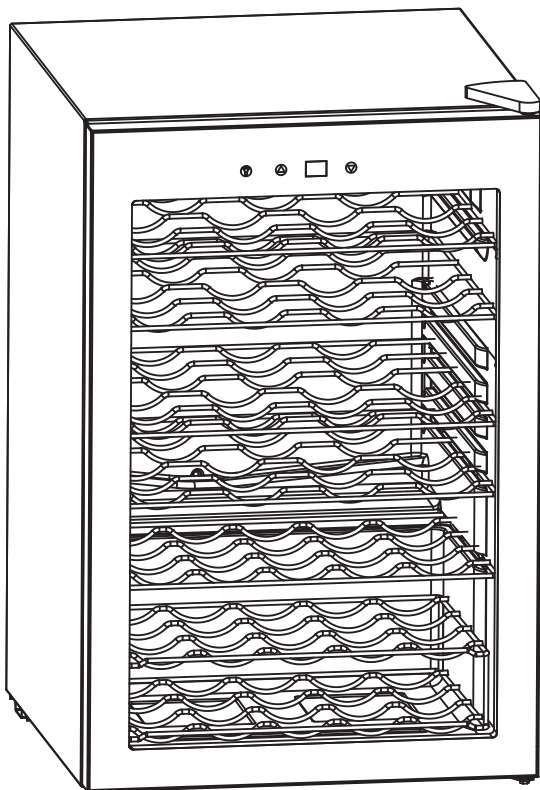

Please Read and Save this Use & Care Book

Congratulations

Dear Customer:

Welcome to the our family. Thank you for purchasing one of our products.

Our goal is to provide you with superior service. If there is anything missing from or wrong with your order, or if you have any questions about using our product, PLEASE contact us.

Email: support@homyd.com

Our team is available 24/7 to address your questions, comments, and concerns. Your satisfaction is our ultimate goal. We want to make everything right so you'll share your positive experience with other shoppers on Amazon.

If you experience any problems, please send an email to support@homyd.com

Our mission:

- * To be the most trusted appliance brand.
- * To create practical, compact appliances that better your life.

Contents

General Safety Rules	03-05
Parts and Features	06
Installing Your Beverage And Wine Center	07-08
Beverage And Wine Center Features and Use	09-11
Proper Beverage And Wine Center Care & Cleaning	12-13
Warranty	14
Trouble Shooting	15

| General Safety Rules

Before you use your refrigerator, please read this owners manual carefully.

Use this appliance only for its intended purpose as described in this owner's manual.

DANGER : Risk of child entrapment. Before you throw away your old refrigerator or freezer:

- Take off the doors.
- Leave the shelves in place so that children may not easily climb inside.
- The appliance must be correctly installed and connected to the power supply in accordance with the installation instructions before it is used.. (See: "Installing Your Beverage And Wine Center").
- The main power supply must be properly grounded.
- This refrigerator must be positioned so that the plug is accessible. Never unplug you unit often by pulling on the power cord. Always grasp the plug firmly and pull straight out from the outlet.
- Do not use an extension cord as this can negatively affect the performance of the unit
- When transporting the refrigerator, keep the unit in the upright position. Do not tilt the appliance beyond 45° or place the unit in upside down position. Do not tip over.
- Do not touch the cooled surfaces while the appliance operates, especially not with wet hands, because Hie skin may stick to the cold surfaces.

General Safety Rules

- It is recommended that the refrigerator is positioned away from any combustible sources such as gas, petrol, alcohol, lacquer and banana oil, etc.
The aforementioned objects should not be stored in the refrigerator under any circumstances.
- If the unit fails to cool properly, dispose of spoiled food as needed.
- Unplug your unit before cleaning or before making any repairs.
NOTE: If for any reason this product requires service, we strongly recommend that a certified technician perform the service.
Repairs made by non-qualified personnel will void the warranty.
- Do not defrost the appliance with other electric devices (hair dryer etc.) and never scrape the ice or frost layer with sharp tools.
Warning: Do not damage the refrigerant circuit
- The rating plate is inside the appliance or outside on the rear or side wall.
- This appliance is not intended for use by persons (including children) with reduced physical, sensory or mental capabilities, or lack of experience and knowledge, unless they have been given supervision or instruction concerning use of the appliance by a person responsible for their safety.
Children should be supervised to ensure that they do not play with the appliance.
- Do not run cord over carpeting or other heat insulators.
Do not cover the cord. Keep cord away from traffic areas, and do not submerge in water.
If the supply cord is damaged, it must be replaced by the manufacturer or its service agent or a similarly qualified person in order to avoid a hazard.
Repair or replace immediately all electric service cords that have become frayed or otherwise damaged.
Do not use a cord that shows cracks or abrasion damage along its length, the plug or the connector end.

| General Safety Rules

- Do not operate your refrigerator in the presence of explosive fumes.
- **WARNING**—Do not use the flame or catch the fire near the unit.
- **DANGER**—Risk of fire or Explosion.
Flammable Refrigerant Used.
To Be Repaired Only By Trained Service Personnel. Do Not Puncture Refrigerant Tubing.
- **Caution**—Risk of fire or Explosion.
Dispose Of Property In Accordance With Federal Or Local Regulations.
Flammable Refrigerant Used.
- **CAUTION** – Risk Of Fire Or Explosion.
Flammable Refrigerant Used.
Consult Repair Manual/Owner's Guide Before Attempting To Service This Product.
All Safety Precautions Must be Followed.
- **CAUTION** – Risk Of Fire Or Explosion Due To Puncture Of Refrigerant Tubing; Follow Handling Instructions Carefully.
Flammable Refrigerant Used.

Staple your receipt to your manual.

You will need it to obtain warranty service.

Parts and Features

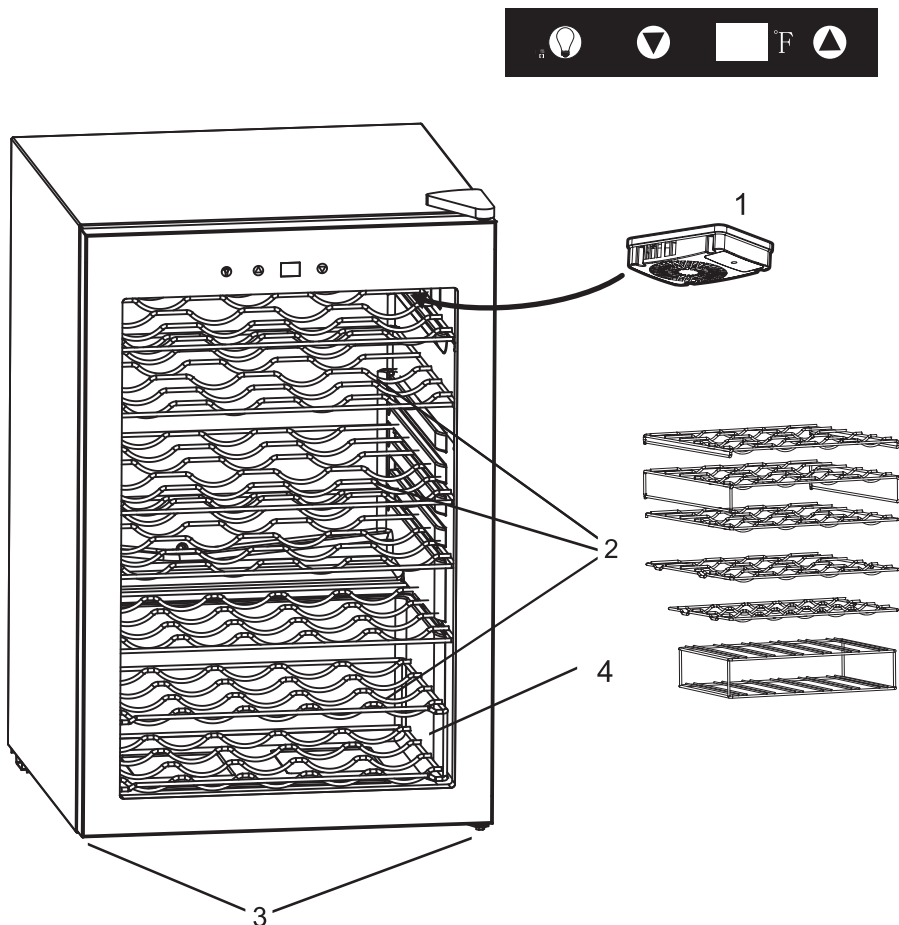

- 1. Interior Light and Fan
- 2. ChromeWire Shelf (6)
- 3. Adjustable Leveling Legs

- 4. Glass Touch Control Panel
- 5. Tinted Double Pane Glass Door
- 6. Drip Tray in Back (not shown)

I Installing Your Beverage And Wine Center

Unpacking Your Beverage And Wine Center

- Remove all packaging material. This includes the foam base and all adhesive tape holding the beverage and wine center accessories inside and outside.
- Inspect and remove any remaining packing, tape or printed materials before powering on the beverage and wine center.

Leveling Your Beverage And Wine Center

- Your beverage and wine center has two leveling legs which are located in the front corners. After properly placing your beverage and wine center in its final position, you can level your beverage and wine center.
- Leveling legs can be adjusted by turning them clockwise to lower your beverage and wine center or by turning them counterclockwise to raise your beverage and wine center. The beverage and wine center door will close more easily when the two front leveling legs are extended slightly.

Proper Air Circulation

- To ensure that your beverage and wine center works at the maximum efficiency it was designed for, you should install it in a location where there is proper air circulation and electrical connections.
- The following are recommended clearances around the beverage center:

Sides	2" (50mm)
Top	2" (50mm)
Back	2" (50mm)
- Do not over fill your beverage and wine center for proper cooling.

Note: If your beverage and wine center has been tilted for any reason, wait 24 hours before plugging it in.

Installing Your Beverage And Wine Center

Drip Tray

- Ensure the drip tray in the rear of the unit is in the proper position.

A WARNING: ELECTRICAL REQUIREMENT – SHOCK HAZARD

Electrical Requirement

- Make sure there is a suitable power outlet (115 volts, 15 amps outlet) with proper grounding to power the beverage and wine center.
- Avoid the use of three prong adapters or cutting off the third grounding prong in order to accommodate a two prong outlet. This is a dangerous practice since it provides no effective grounding for the beverage and wine center and may result in shock hazard.

Installation Limitations

- Do not install your beverage and wine center in any location not properly insulated or heated (e.g.z garage etc.). Your beverage and wine center was not designed to operate in ambient temperature settings below 55° Fahrenheit.
- Select a suitable location for the beverage and wine center on a hard even surface away from direct sunlight or heat source (e.g., radiators, baseboard heaters, cooking appliances, etc.). Any floor unevenness should be corrected with the leveling legs located on the front and rear bottom corners of the beverage and wine center.
- Your beverage and wine center is designed for freestanding installation only. It is not designed for built-in application.
Note: This unit is for indoor use only.

Use of Extension Cord

- Avoid the use of an extension cord because of potential safety hazards under certain conditions.
If it is necessary to use an extension cord, use only a 3-wire extension cord that has a 3-blade grounding plug and a 3-slot outlet that will accept the plug.
The marked rating of the extension cord must be equal to or greater than the electrical rating of the appliance.

| Beverage And Wine Center Features and Use





Control Panel (Fig. 2)

Initial Setup

1. Plug the unit into an electrical outlet. You will hear a beep, which is normal.

The display will revert to the actual internal temperature.

2. The control panel  will be active. You must press  before

accessing any of the control pads.

Control Panel Settings

The adjust temperature range of the beverage and wine center is 40°F to 61 °F.

The LED display shows the actual internal temperature.

Your beverage and wine center when it is first turned on, will have a factory setting of 46°F.

Note: It is normal for the actual temperature to vary slightly during normal operation.

Control Panel Auto-Lock

Your beverage and wine center has an automatic control panel lock. You may manually activate or deactivate the control panel lock by

pressing the control pad



Beverage And Wine Center Features and Use



To operate any of the functions on the control panel, press the control

pad  before making a selection.

The control panel lock will automatically activate if the control panel is not touched for 30 seconds.

Manual Temperature Setting

The adjust temperature range of your beverage and wine center is between 40°F and 61 °F.

The adjust temperature may be set anywhere within this range by pressing the  and  pads. The display is in Fahrenheit only.

1. Press the control pad .

2. After the beep, press the  or  pad to increase or

decrease the temperature in increments of one degree.

The LED readout will reflect each change to the temperature setting.

3. Once the desired setting has been reached, press the control panel

 pad.

Interior Light (see Fig. 2)

To complement the look of your beverage and wine center, a soft light has been built into the beverage and wine center.

Simply push the  pad and the light comes on, push again to turn off.

For maximum energy efficiency, leave the light off when not viewing your collection.

Please Note: The light will not activate "ON" if the lock button is "ON".

| Beverage And Wine Center Features and Use

Shelving (See Fig. #2)

To remove or replace a full-width slide-out shelf:

1. Gently tilt the shelf up and slide forward until the shelf has been completely removed.
2. To replace the shelf, gently slide the shelf back.

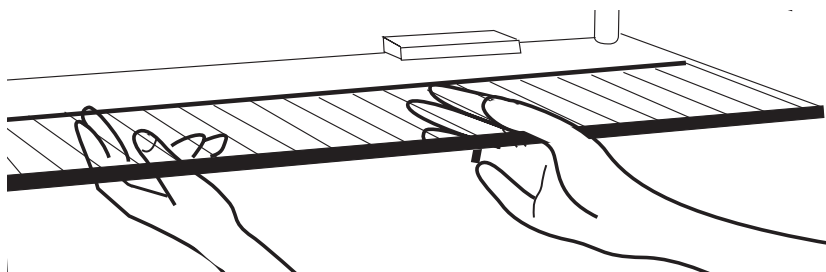

Fig. #2

Normal Operating Sounds You May Hear

Boiling water, gurgling sounds or slight vibrations that are the result of the refrigerant circulating through the cooling coils.

Compressor makes operational sounds v/hen cycling on and off.

| Proper Beverage And Wine Center Care & Cleaning

Cleaning and Maintenance

A Warning: To avoid electric shock, always unplug your beverage and wine center before cleaning. Ignoring this warning may result in death or injury.

A Caution: Before using cleaning products, always read and follow manufacturer's instructions and warnings to avoid personal injury or product damage.

General: Prepare a cleaning solution of 3-4 tablespoons of baking soda mixed with warm water. Use sponge or soft cloth, dampened with the cleaning solution, to wipe down your beverage center.

Rinse with clean warm water and dry with a soft cloth.

Do not use harsh chemicals or abrasives, ammonia, chlorine bleach, concentrated detergents, solvents or metal scouring pads. Some of these chemicals may dissolve, damage and/or discolor your beverage and wine center.

Door Gaskets: Clean door gaskets every three months according to general instructions. Gaskets must be kept clean and pliable to assure a proper seal.

Petroleum jelly applied lightly on the hinge side of gaskets will keep the gasket pliable and ensure a good seal.

| Proper Beverage And Wine Center Care & Cleaning

Defrosting Ybur Beverage And Wine Center

Your beverage and wine center is designed with a manual defrost system.

The beverage and wine center surfaces will defrost, when the unit is unplugged.

Water from the unit is disposed of automatically, by means of being channeled onto a drip tray located on the compressor.

Heat transfer from the compressor causes this water to evaporate.

Power Interruptions

- Occasionally there may be power interruptions due to thunderstorms or other causes.
Remove the power cord from AC outlet when a power outage occurs.
When power has been restored, replugin power cord to AC outlet.
- The unit will revert to the factory setting of 46°F after any power outage.
Reset your temperature selection.
Vacation and Moving Care

Vacation and Moving Care

- For long vacations or absences, empty contents from beverage and wine center, unplug the unit and clean the beverage and wine center and door gaskets according to "General cleaning" section.
Prop doors open, so air can circulate inside.
When moving, always move the beverage and wine center vertically.
Do not move with the unit lying down.
Possible damage to the sealed system could occur.

Warranty

We offers a limited 1-year warranty ("warranty period") on all of our products purchased new and unused from us with an original proof of purchase and where a defect has arisen, wholly or substantially, as a result of faulty manufacture, parts, or workmanship during the warranty period. The warranty does not apply where damage is caused by other factors, including without limitation:

- (a) normal wear and tear;
- (b) abuse, mishandling, accident, or failure to follow operating instructions;
- (c) exposure to liquid or infiltration of foreign particles;
- (d) servicing or modifications of the product other than by our company;

Our warranty covers all costs related to restoring the proven defective product through repair or replacement of any defective part and necessary labor so that it conforms to its original specifications.

A replacement product may be provided instead of repairing a defective product.

Our sole obligation under this warranty is limited to such repair or replacement.

A receipt indicating the purchase date is required for any claim, so please keep all receipts in a safe place.

Although greatly appreciated, the product registration is not required to activate any warranty, and product registration does not eliminate the need for the original proof of purchase.

The warranty will be voided if repairs are performed by a non-authorized third party and/or if spare parts other than those provided by the Company are used.

You may also arrange for service after the warranty expires, at an additional cost. These are our general terms for warranty service, but we always urge our customers to reach out to us with any issue, regardless of warranty terms. If you have an issue with our products, please contact us (support@homyd.com), and we will do our best to resolve it for you.

I Trouble Shooting

Problem	Possible Causes
Control Panel does not respond	<ul style="list-style-type: none"> • Check if control panel  is on
Beverage And Wine Center Does Not Operate	<ul style="list-style-type: none"> • Check if beverage and wine center is plugged in. • Check if there is power at the ac outlet, by checking the circuit breaker. • Check if power pad is on.
Temperature appears too warm	<ul style="list-style-type: none"> • Frequent door openings. • Allow time for recently added beverages to reach proper temperature. • Check gaskets for proper seal. • Adjust temperature control to cooler setting.
Temperature is too cold	<ul style="list-style-type: none"> • If temperature control setting is too cold, adjust to a warmer setting and allow several hours for temperature to adjust.
Beverage And Wine Center runs too frequently	<ul style="list-style-type: none"> • This may be normal to maintain constant temperature during high temperature and humid days. • Doors may have been opened frequently or for an extended period of time. • Check gasket for proper seal. • Check to see if doors are completely closed.
Moisture build up on interior or exterior of the beveragecenter	<ul style="list-style-type: none"> • This is normal during high humidity periods. • Prolonged or frequent door openings. • Check door gaskets for proper seal.
Beverage And Wine center door does not shut properly	<ul style="list-style-type: none"> • Level the beverage and wine center. • Check for blockages.

